



**Upper  
Wharfedale  
Primary  
Federation**

## Grassington Newsletter 16th January

Welcome to this week's newsletter.

We hope you've all had a fantastic week! This edition will be short and sweet, but don't miss out—inside you'll find an exciting announcement, updates on running events, and essential safeguarding and school information.

Wishing you a restful and enjoyable weekend!

[Exciting announcement: Trim Trail at Grassington](#)



**YORKSHIRE DALES**  
National Park Authority  
Sustainable Development Fund

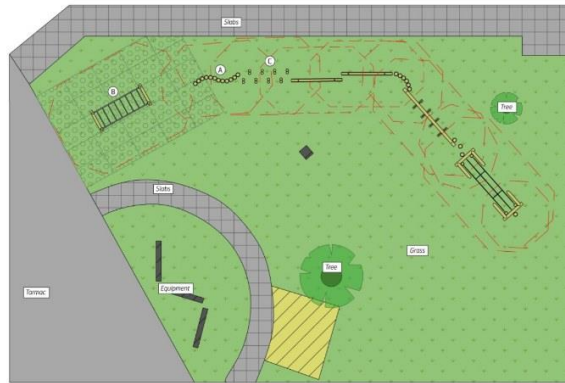

We are really excited to share that next week, we will be having a Trim Trail installed at Grassington. This has been funded through generous support of Grassington PTA and incredible grants from Yorkshire Dales Millennium Trust (YDMT) and The Yorkshire Dales National Park Authority's Sustainable Development Fund. We are so lucky to be supported by these amazing funds and cannot wait to see the super new trail which will enhance our outdoor environment. We know it will bring a lot of joy to all the children at Grassington as well as Federation wide when they visit on a Friday.

The Yorkshire Dales National Park Authority's Sustainable Development Fund is open to individuals, businesses, community groups or voluntary sector bodies. It provides an accessible source of money for a range of projects that result in positive benefits for the National Park's environment, economy and communities, while enhancing and conserving local culture, wildlife and landscape. [Sustainable Development Fund \(SDF\) - Yorkshire Dales National Park : Yorkshire Dales National Park](#)

Yorkshire Dales Millennium Trust is a small charity doing big things for the people, landscape and wildlife of the Yorkshire Dales and surrounding area. This special area inspires us to be ambitious, and we have always prided ourselves on being an organisation that makes a practical difference and "gets stuff done." [Yorkshire Dales Millennium Trust | Working together for the Dales](#)



## Cross Country



**Tuesday 20th January Cluster Cross Country Event - Cancelled. Rearranged to Tuesday 3rd February.**

We also have 2 further Keighley Cross Country league events coming up

- **Wednesday, 4th February 2026** – Cliffe Castle, Keighley
- **Tuesday, 10th March 2026** – Marley Playing Fields, Keighley (All races start at 3:15 pm)

*Emails with full information has been sent to registered runners. If your KS2 child is not registered and would like to run, please let us know by Monday.*

## Screen Time



You may have seen in the news this week that the Government is reviewing screen time guidelines for children under five, following research showing that high levels of screen time can limit vocabulary development in toddlers. This has prompted renewed discussion about how and when young children use screens at home.

Screens themselves aren't the enemy, but how children use them, how often, and with whom makes a big difference. Young children learn best through real-life interaction, play, and conversation with adults.

### **Other concerns linked to too much screen time**

Alongside language development, research suggests that excessive screen use in young children may also be linked to:

- **Reduced attention and concentration**, especially with fast-paced or highly stimulating content
- **Fewer opportunities for active play**, which supports physical development and coordination
- **Increased frustration or emotional dysregulation**, particularly when screens are removed
- **Less social interaction**, which is vital for learning turn-taking, listening, and communication skills

### **Helpful tips for parents:**

- **Talk more than you tap** – chatting, singing, reading stories, and naming everyday objects all help build vocabulary.
- **Choose quality over quantity** – if screens are used, opt for age-appropriate, educational content.
- **Watch together** – talking about what's on the screen helps turn screen time into a learning opportunity.
- **Set clear limits** – short, planned screen sessions are better than unrestricted use.
- **Create screen-free moments** – mealtimes, playtime, and bedtime are ideal opportunities for conversation.
- **Lead by example** – children copy adults, so putting phones away during family time makes a big impact.

Remember, screens are not essential for early learning. Everyday moments such as playing, reading, talking, and sharing routines are some of the most powerful ways to support your child's development.

## Other Opportunities



### Wild Explorers: Into The Wild

A 2-day experience for young people aged 10 - 16. Into The Wild provides an opportunity for young people to unplug from technology and benefit from all that nature has to offer.

Into The Wild is a 2-day experience that will give young people (10-16 years) increased responsibility and challenge.

You will have the opportunity to set up your own shelter, make your own campfire, plan the menu and cook the food on the fire along with other activities on the day.

The 2 days will be centred around building confidence, leadership, teamwork and resilience.



**Price**  
£95 per child for 2 days inc food  
Childcare vouchers accepted

**Age**  
10 - 16 years  
Must be in year 6 or above

**Upcoming Dates**  
16<sup>th</sup> & 17<sup>th</sup> February 2026

*Please note: this is a 2 day experience.*



**Time**  
9.30am - 3.30pm

**Location**  
Broughton Hall Estate



[hello@wildexplorers.org.uk](mailto:hello@wildexplorers.org.uk) [www.wildexplorers.org.uk](http://www.wildexplorers.org.uk)



### Wild Explorers

Where nature, fun and adventure collide!

A child-led, fun and nurturing holiday club set in beautiful woodland on the Broughton Estate.

We are an OFSTED registered outdoor holiday club where children can play, enjoy a campfire, woodland crafts, tools and much more!



**Price**  
£35 per child per day  
Childcare vouchers accepted

**Age**  
Reception - Age 13

**Upcoming Dates**  
16<sup>th</sup> - 20<sup>th</sup> February 2026



**Time**  
9.30am - 3.30pm

**Location**  
Broughton Hall Estate



[hello@wildexplorers.org.uk](mailto:hello@wildexplorers.org.uk) [www.wildexplorers.org.uk](http://www.wildexplorers.org.uk)



NORTH YORKSHIRE COUNCIL



# RE-IMAGINE A CLASSIC CHILDREN'S ART COMPETITION

Calling all young artists!

Get ready to dive into your imagination... What would Alice in Wonderland look like today? Who might join Mowgli in The Jungle Book? It's your chance to give a classic story a modern twist!

👧 For ages: 4-11

📍 Hand in at: Skipton Library

🕒 Deadline: 1.30pm, 21<sup>st</sup> February

Please include the child's full name, age, and a parent or guardian's email address.







NORTH YORKSHIRE COUNCIL

# RE-IMAGINE A CLASSIC CHILDREN'S ART COMPETITION

Calling all young artists!

Get ready to dive into your imagination... What would Alice in Wonderland look like today? Who might join Mowgli in The Jungle Book? It's your chance to give a classic story a modern twist!

Create your artwork using any traditional medium - pencils, paint, collage, pastels (No AI, please - we want your own genius!)

Two age categories:

- 4-7 years
- 8-11 years

One winner from each group will be chosen by bestselling author Anna James, creator of Pages & Co, The Chronicles of Whetherwhy, and Alice With a Why.

Submit your artwork at Skipton Library (physical entries only) by 1.30pm on Saturday 21st February 2026.

Remember to include your full name, age, and a parent/guardian's email - entries without this can't be judged.

All artwork will be displayed at Skipton Library from 23rd Feb-8th Mar, with prizes awarded on 1st March.







## Grassington News



### **Class 1 Craft Club**

We have confirmation from Anne Peart of Project Reverb that the Craft Club will continue this term for years Reception, Year 1 and Year 2.

Day: Tuesdays (starting 20th January)

Time: 3:30pm to 4:30pm

Cost: FREE!

*Please let us know by email if you would like your child/children to attend.*

**Dinner Money** - reminder to prepay for this term please.

## Shine Awards



### Class 1

**Abbie** - for your fantastic focus and determination in your writing this week! You have written with great independence, focusing hard on your presentation and spelling skills! Great work!

**Noah** - for using your Superworm skills to make your very own amazing story book! Well done Noah!

### Class 2 -

**Elliott, Beau, Finn, Jacob, Teddy, Henry, Isla A, Isla M, Lucy, Connie, Agatha, Aurelia, Poppy, Elise, Delilah** - showing an excellent attitude towards assessment week - enthusiasm, care and determination shown in all their work this week - well done!

### Class 3 -

**Penny** - this girl brings so much to Class 3 and our school community. She is always ready to help and this week she has shown us true perseverance and determination in our assessments. Thank you for being you Penny!

**Bertie** - for a brilliant eye-witness account of how it would have felt to be at the eruption of Mount Vesuvius. Brilliant description and you read out with such confidence.

## House Points



### THIS WEEK

Post Office 147 | Dales Market Square 145 | Strikey Badger 197 | Fell Rescue 148 | Total 587

### TO DATE

Post Office 1,465 | Dales Market Square 1,367 | Strikey Badger 1,648 | Fell Rescue 1,737 | Total 6,217

## Key Diary Dates for Spring Term

**DATES TO  
REMEMBER**

### Spring 1

**Friday 30th January - Stay and Play in Preschool**

**Wednesday 4th February - Cliffe Castle Cross Country 3:15pm**

**W/B Monday 9th February - Mental Health Week**

**Monday 9th February - Cracoe and Kettlewell Murton Park Trip for Year 3-6**

**Friday 13th February - Schools close for half term**

**Spring 2**

**Monday 23rd February - Schools Open**

**Wednesday 25th February - Planetarium visit class 1**

**Thursday 26th February - Grassington and Burnsall Murton Park trip for Year 3-6**

**Friday 27th February - Stay and Play in Preschool**

**Thursday 5th March - World Book Day**

**Tuesday 10th March - Cross Country Event at Marley 3:15pm**

**W/B 23rd March - Parents' Evenings**

**Wednesday 25th or Thursday 26th March - Easter Fun and Easter Services**

**Thursday 26th March - Cross Country Final at Cliffe Castle for those who qualify**

**Friday 27th March - Stay and Play in Preschool**

**Friday 27th March - Schools close for Easter**

**Wishing you a wonderful weekend**

**Claire Greenwood and Wendy Thompson**

**Co-Executive Headteachers**